

Memo

Legal and Democratic Services

To: For Circulation See Below

Development & Regulatory Law Team
City Hall
Bradford
West Yorkshire
BD1 1HY
DX11758 BRADFORD -1

Ref: 12/00020/G

From: C E Barrott
Legal Officer
Development and Regulatory Law Team

Date: 31 July 2012

Tel: (01274) 434751
Fax: (01274) 434242
My Ref: LEG/DEV/CEB/71877
Email: carole.barrott@bradford.gov.uk

**TOWN AND COUNTRY PLANNING ACT 1990 - SECTION 198
LAND AT CARLTON ROAD SALTAIRE SHIPLEY - TREE PRESERVATION ORDER**

The above Tree Preservation Order was made on 31st July 2012. Please find attached a copy for your records.

C. E. Barrott

C E Barrott

Enc

Arboricultural Technician
Development Services Tree Section
Department of Regeneration
3rd Floor, Jacobs Well

Land Charges Manager
Local Land Charges
6th Floor Jacobs Well

For TPO's in Shipley Area (including Bingley,
Wilsden, Harden, Cullingworth, Baildon)
Shipley Planning Reception
Department of Corporate Services
Ground Floor
Shipley Town Hall



G:\DEVELOPMENT\STDS\TP11.DOT (Revised June 2011)

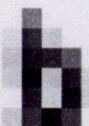

Suzan Hemingway - City Solicitor

TOWN AND COUNTRY PLANNING ACT 1990
THE LAND AT CARLTON ROAD SALTAIRE SHIPLEY
TREE PRESERVATION ORDER 2012

The City of Bradford Metropolitan District Council in exercise of the powers conferred on them by Section 198 of the Town and Country Planning Act 1990 make the following Order:-

Citation

1. This Order may be cited as land at Carlton Road Saltaire Shipley Tree Preservation Order 2012.

Interpretation

2. (1) In this Order "the authority" means City of Bradford Metropolitan District Council.

(2) In this Order any reference to a numbered section is a reference to the section so numbered in the Town and Country Planning Act 1990 and any reference to a numbered regulation is a reference to the regulation so numbered in the Town and Country Planning Act (Tree Preservation) (England) Regulations 2012.

Effect

3. (1) Subject to article 4, this Order takes effect provisionally on the date on which it is made.

(2) Without prejudice to subsection (7) of section 198 (power to make tree preservation orders) or subsection (1) of section 200 (tree preservation orders: Forestry Commissioners) and, subject to the exception in regulation 14, no person shall:-
 - (a) cut down, top, lop, uproot, wilfully damage, or wilfully destroy; or
 - (b) cause or permit the cutting down, topping, lopping, wilful damage or wilful destruction of,

any tree specified in the Schedule to this Order except with the written consent of the authority in accordance with regulations 16 and 17, or of the Secretary of State in accordance with regulation

LAND AT CARLTON ROAD, SALTAIRE

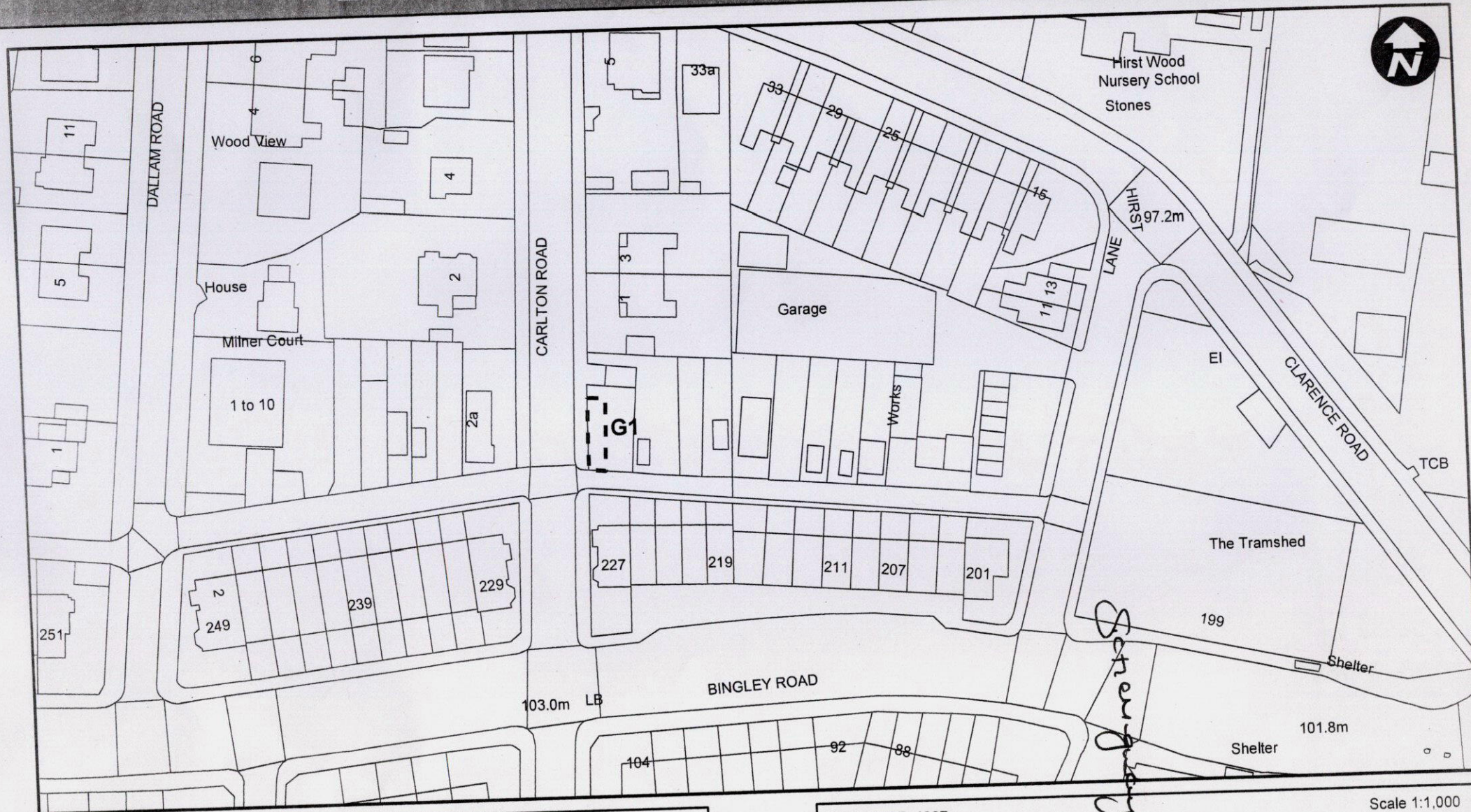

Tree Preservation Order
12/00020/G
LAND AT CARLTON ROAD,
SALTAIRE

DEPARTMENT OF REGENERATION &
CULTURE
Jacobs Well
Bradford
BD1 5RW

OS Ref : SE 1337
Reproduced from the Ordnance Survey map with
the sanction of HM Stationery Office
Crown Copyright reserved
LA076120

Scale 1:1,000

May 2012

23 and, where such consent is given subject to conditions, in accordance with those conditions.

Application to trees to be planed pursuant to a condition

- 4. In relation to any tree identified in the first column of the Schedule by the letter "C", being a tree to be planted pursuant to a condition imposed under paragraph (a) of section 197 (planning permission to include appropriate provision for preservation and planting of trees), this Order take effect as from the time when the tree is planted.

Dated this 31st day of July 2012.

EXECUTED AS A DEED by affixing
THE COMMON SEAL of **THE CITY**
OF BRADFORD METROPOLITAN
DISTRICT COUNCIL in the presence of:-

Schenegway

Authorised by the City Solicitor

94798

CONFIRMATION OF ORDER

This Order was confirmed by the City of Bradford Metropolitan District Council without modification on the _____ day of _____

OR

The Order was confirmed by the City of Bradford Metropolitan District Council subject to the modification indicated by _____ on the _____ day of _____

EXECUTED AS A DEED by affixing
THE COMMON SEAL of **THE CITY**
OF BRADFORD METROPOLITAN
DISTRICT COUNCIL in the presence of:-

Authorised by the City Solicitor

DECISION NOT TO CONFIRM

A decision not to confirm this Order was taken by the City of Bradford Metropolitan District Council on the day of

EXECUTED AS A DEED by affixing
THE COMMON SEAL of **THE CITY**
OF BRADFORD METROPOLITAN
DISTRICT COUNCIL in the presence of:-

Authorised by the City Solicitor

VARIATION OF ORDER

This Order was varied by the City of Bradford Metropolitan District Council on the
day of by a variation order under reference number
a copy of which is attached.

EXECUTED AS A DEED by affixing
THE COMMON SEAL of **THE CITY**
OF BRADFORD METROPOLITAN
DISTRICT COUNCIL in the presence of:-

Authorised by the City Solicitor

REVOCATION OF ORDER

This Order was revoked by the City of Bradford Metropolitan District Council on
the day of

EXECUTED AS A DEED by affixing
THE COMMON SEAL of **THE CITY**
OF BRADFORD METROPOLITAN
DISTRICT COUNCIL in the presence of:-

Authorised by the City Solicitor

SCHEDULE**Specification of Trees****Trees specified individually**

(encircled in black on the map)

Reference on map	Description	Situation
NONE		

Trees specified by reference to an area

(within a dotted black line on the map)

Reference on map	Description	Situation
NONE		

Groups of trees

(within a broken black line on the map)

Reference on map	Description	Situation
G1	1 Sycamore, 1 Ash	413449 437788

Woodlands

(within a continuous black line on the map)

Reference on map	Description	Situation
NONE		